

APPROVED FOR CONSTRUCTION

CARDINIA SHIRE COUNCIL

Ref No.: **STAGE 2**
 Sheet: **5 of 40**
 Approved by: Justin Conn
 CARDINIA SHIRE COUNCIL
 Date: Thursday, 6 October 2022

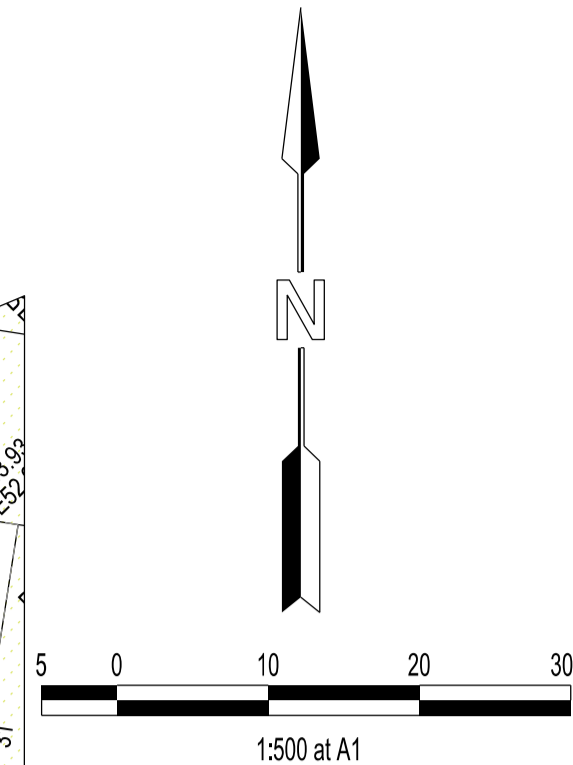
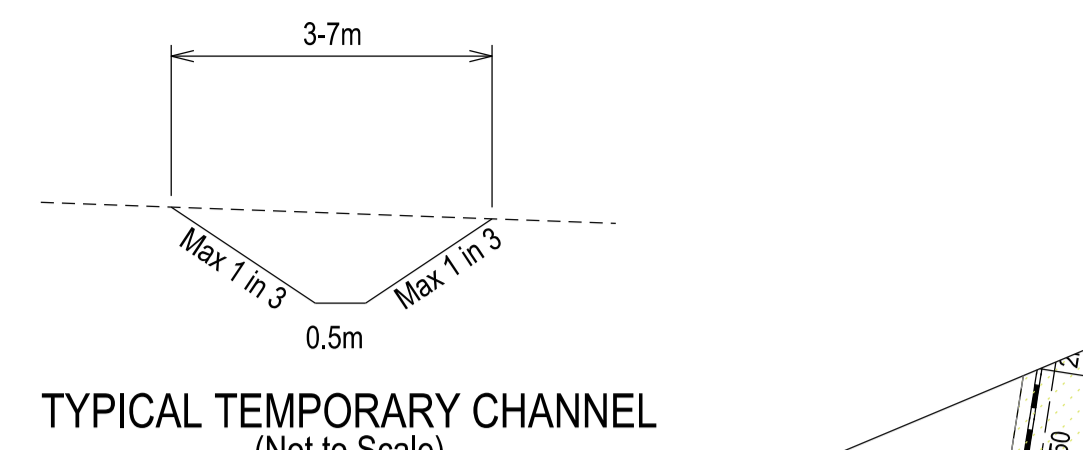
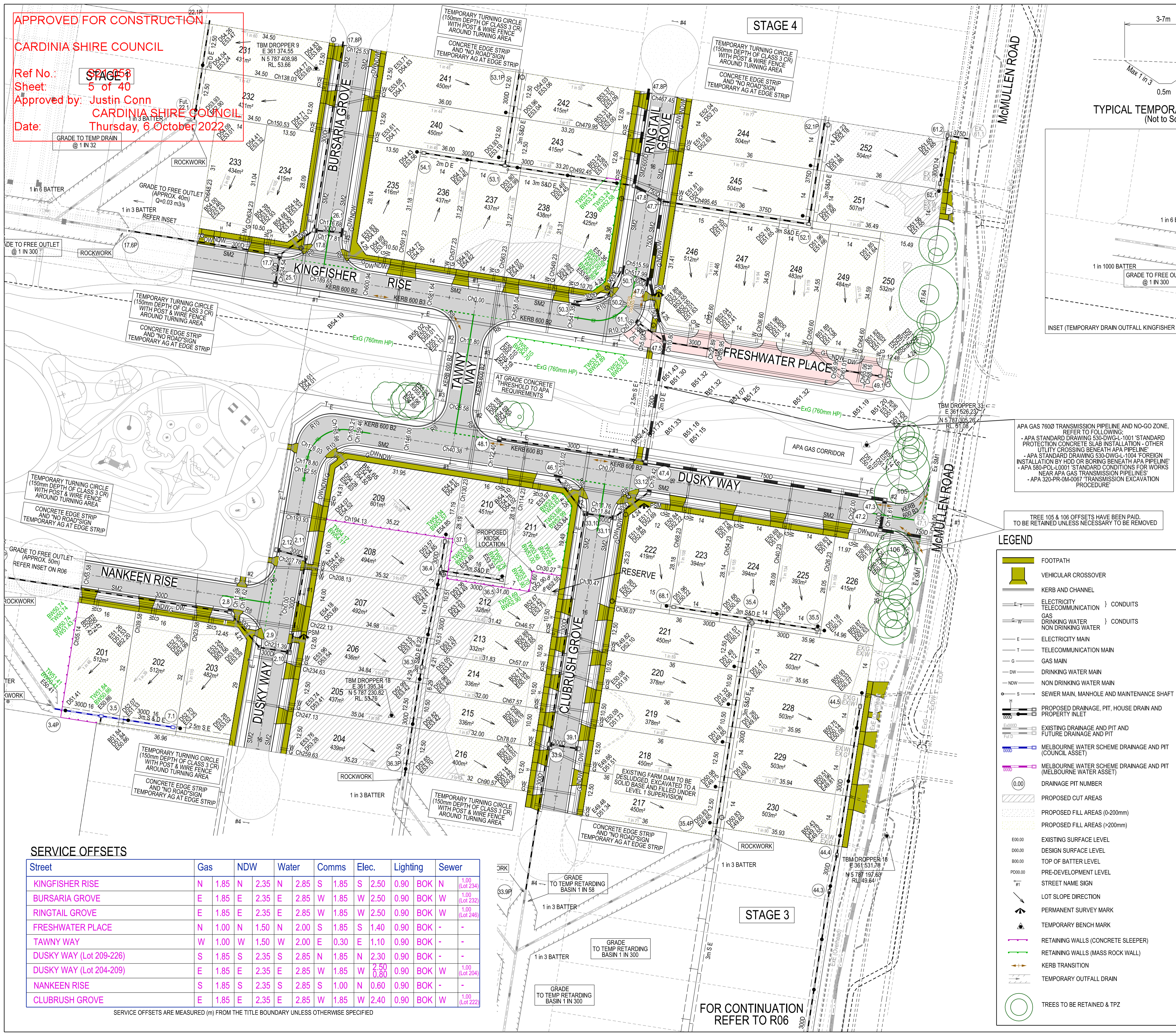

WARNING
OVERHEAD POWER LINES

STOP Major Cables exist in the area, if your activities are within Telstra encroachment distances (see duty of care) contact 03 9632 9961 at least 2 business days before starting activity.

WARNING
BEWARE OF UNDERGROUND SERVICES
 THE LOCATIONS OF UNDERGROUND SERVICES ARE APPROXIMATE ONLY AND THEIR EXACT POSITION SHOULD BE PROVEN ON SITE. NO GUARANTEE IS GIVEN THAT ALL EXISTING SERVICES ARE SHOWN.

APA GAS 7600 TRANSMISSION PIPELINE AND NO-GO ZONE. REFER TO FOLLOWING:
 - APA STANDARD DRAWING 530-DWG-L-1001 'STANDARD PROTECTION CONCRETE SLAB INSTALLATION - OTHER UTILITY CROSSING BENEATH APA PIPELINE'
 - APA STANDARD DRAWING 530-DWG-L-1004 'FOREIGN INSTALLATION BY HDD OR BORING BENEATH APA PIPELINE'
 - APA 580-POL-L001 'STANDARD CONDITIONS FOR WORKS NEAR APA GAS TRANSMISSION PIPELINES'
 - APA 320-PR-0M-0067 'TRANSMISSION EXCAVATION PROCEDURE'

TREE 105 & 106 OFFSETS HAVE BEEN PAID. TO BE RETAINED UNLESS NECESSARY TO BE REMOVED

LEGEND

- FOOTPATH
- VEHICULAR CROSSOVER
- KERB AND CHANNEL
- ELECTRICITY TELECOMMUNICATION } CONDUITS
- GAS } CONDUITS
- DRINKING WATER } CONDUITS
- NON DRINKING WATER } CONDUITS
- ELECTRICITY MAIN
- TELECOMMUNICATION MAIN
- GAS MAIN
- DRINKING WATER MAIN
- NON DRINKING WATER MAIN
- SEWER MAIN, MANHOLE AND MAINTENANCE SHAFT
- PROPOSED DRAINAGE, PIT, HOUSE DRAIN AND PROPERTY INLET
- EXISTING DRAINAGE AND PIT AND FUTURE DRAINAGE AND PIT
- MELBOURNE WATER SCHEME DRAINAGE AND PIT (COUNCIL ASSET)
- MELBOURNE WATER SCHEME DRAINAGE AND PIT (MELBOURNE WATER ASSET)
- DRAINAGE PIT NUMBER
- PROPOSED CUT AREAS
- PROPOSED FILL AREAS ($0-200\text{mm}$)
- PROPOSED FILL AREAS (>200mm)
- EXISTING SURFACE LEVEL
- DESIGN SURFACE LEVEL
- TOP OF BATTER LEVEL
- PRE-DEVELOPMENT LEVEL
- STREET NAME SIGN
- LOT SLOPE DIRECTION
- PERMANENT SURVEY MARK
- TEMPORARY BENCH MARK
- RETAINING WALLS (CONCRETE SLEEPER)
- RETAINING WALLS (MASS ROCK WALL)
- KERB TRANSITION
- TEMPORARY OUTFALL DRAIN
- TREES TO BE RETAINED & TPZ

SERVICE OFFSETS

Street	Gas	NDW	Water	Comms	Elec.	Lighting	Sewer
KINGFISHER RISE	N 1.85	N 2.35	N 2.85	S 1.85	S 2.50	0.90	BOK N 1.00 (Lot 234)
BURSARIA GROVE	E 1.85	E 2.35	E 2.85	W 1.85	W 2.50	0.90	BOK W 1.00 (Lot 232)
RINGTAIL GROVE	E 1.85	E 2.35	E 2.85	W 1.85	W 2.50	0.90	BOK W 1.00 (Lot 246)
FRESHWATER PLACE	N 1.00	N 1.50	N 2.00	S 1.85	S 1.40	0.90	BOK - -
TAWNY WAY	W 1.00	W 1.50	W 2.00	E 0.30	E 1.10	0.90	BOK - -
DUSKY WAY (Lot 209-226)	S 1.85	S 2.35	S 2.85	N 1.85	N 2.30	0.90	BOK - -
DUSKY WAY (Lot 204-209)	E 1.85	E 2.35	E 2.85	W 1.85	W 2.50	0.80	BOK W 1.00 (Lot 204)
NANKEEN RISE	S 1.85	S 2.35	S 2.85	S 1.00	N 0.80	0.90	BOK - -
CLUBBRUSH GROVE	E 1.85	E 2.35	E 2.85	W 1.85	W 2.40	0.90	BOK W 1.00 (Lot 222)

SERVICE OFFSETS ARE MEASURED (m) FROM THE TITLE BOUNDARY UNLESS OTHERWISE SPECIFIED

FOR CONTINUATION REFER TO R06

VERSION DETAILS:

REV	DATE	DESCRIPTION	STATUS
A	17/08/2021	PRELIMINARY PLANS	PRELIMINARY
B	27/09/2021	KERB CHANGES & RETAINING WALL DETAILS	PRELIMINARY
C	21/12/2021	DRIVEWAY CHANGES LOTS 201 & 202	PRELIMINARY
D	11/5/2022	SEQUENCE CHANGE AMENDMENTS	PRELIMINARY
E	21/6/2022	COUNCIL COMMENTS DATED 15/6/2022	PRELIMINARY
F	6/9/2022	CONSTRUCTION ISSUE	PRELIMINARY

FILENAME: P:\1365\1365_2\E12 - Design\6 - DGN\R05.dgn

DRAWN: LS	DATE: AUG 2021	SCALE: AS SHOWN
DESIGNED: ML	DATE: AUG 2021	DATE PRINTED: 6/09/2022
AUTHORISED: TS	DATE: AUG 2021	

COUNCIL: CARDINIA SHIRE
 TITLE: SOUTHERN SUSTAINABLE DEVELOPMENTS (OFFICER) PTY LTD
 ARBOR - STAGE 2
 STARLING ROAD, OFFICER
 DETAIL PLAN & SERVICE OFFSET TABLE - SHEET 1

DRG NO. 1365_2_R05	REV. F	SHEET 05 OF 40
--------------------	--------	----------------

FOR CONTINUATION REFER TO R05

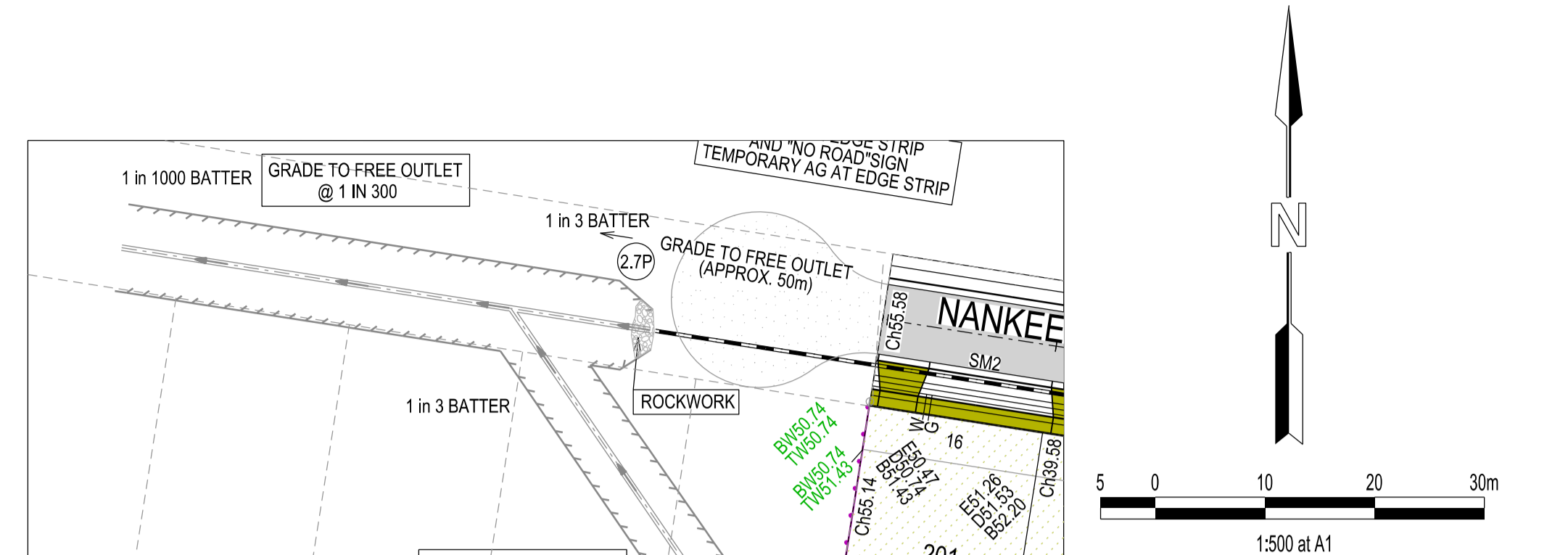
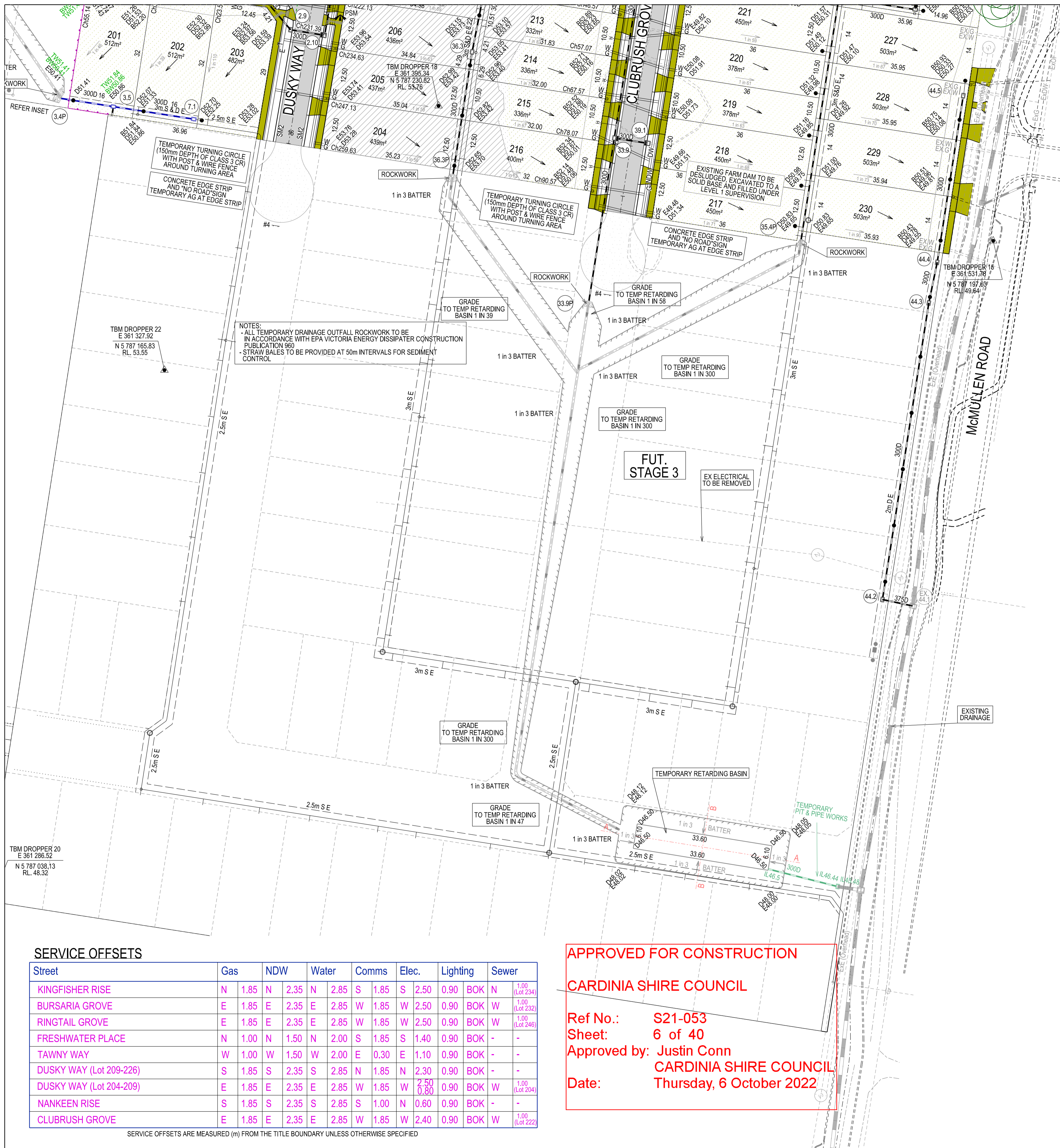

WARNING
OVERHEAD POWER LINES

Major Cables exist in the area, if your activities are within Telstra encroachment distances (see duty of care) contact 03 9632 9961 at least 2 business days before starting activity.

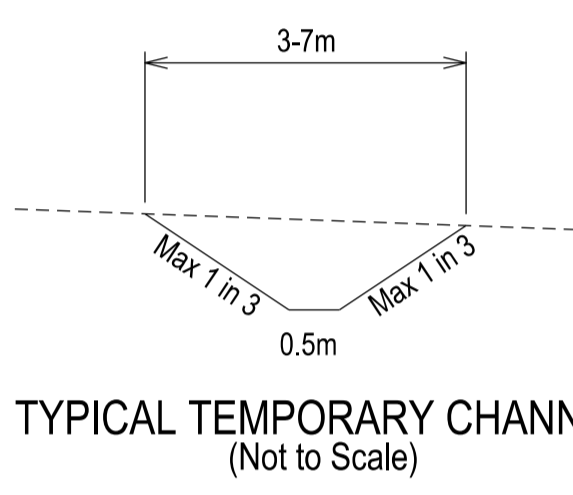

WARNING
BEWARE OF UNDERGROUND SERVICES

THE LOCATIONS OF UNDERGROUND SERVICES ARE APPROXIMATE ONLY AND THEIR EXACT POSITION SHOULD BE PROVEN ON SITE. NO GUARANTEE IS GIVEN THAT ALL EXISTING SERVICES ARE SHOWN.

LEGEND

- FOOTPATH
- VEHICULAR CROSSOVER
- KERB AND CHANNEL
- ELECTRICITY TELECOMMUNICATION } CONDUITS
- GAS DRINKING WATER NON DRINKING WATER } CONDUITS
- ELECTRICITY MAIN
- TELECOMMUNICATION MAIN
- GAS MAIN
- DRINKING WATER MAIN
- NON DRINKING WATER MAIN
- SEWER MAIN, MANHOLE AND MAINTENANCE SHAFT
- PROPOSED DRAINAGE, PIT, HOUSE DRAIN AND PROPERTY INLET
- EXISTING DRAINAGE AND PIT AND FUTURE DRAINAGE AND PIT
- MELBOURNE WATER SCHEME DRAINAGE AND PIT (COUNCIL ASSET)
- MELBOURNE WATER SCHEME DRAINAGE AND PIT (MELBOURNE WATER ASSET)
- DRAINAGE PIT NUMBER
- PROPOSED CUT AREAS
- PROPOSED FILL AREAS (>200mm)
- PROPOSED FILL AREAS (>200mm)
- EXISTING SURFACE LEVEL
- DESIGN SURFACE LEVEL
- TOP OF BATTER LEVEL
- PRE-DEVELOPMENT LEVEL
- STREET NAME SIGN
- LOT SLOPE DIRECTION
- PERMANENT SURVEY MARK
- TEMPORARY BENCH MARK
- RETAINING WALLS (CONCRETE SLEEPER)
- RETAINING WALLS (MASS ROCK WALL)
- KERB TRANSITION
- TEMPORARY OUTFALL DRAIN
- TREES TO BE RETAINED & TPZ

VERSION DETAILS:

REV	DATE	DESCRIPTION	STATUS
A	17/08/2021	PRELIMINARY PLANS	PRELIMINARY
B	27/09/2021	KERB CHANGES & RETAINING WALL DETAILS	PRELIMINARY
C	21/12/2021	DRIVEWAY CHANGES LOTS 201 & 202	PRELIMINARY
D	11/5/2022	SEQUENCE CHANGE AMENDMENTS	PRELIMINARY
E	21/6/2022	COUNCIL COMMENTS DATED 15/6/2022	PRELIMINARY
F	6/9/2022	CONSTRUCTION ISSUE	PRELIMINARY

FILENAME: P:\1365\1365_2\E2 - Design\6 - DGN\R06.dgn

DRAWN: LS DATE: AUG 2021 SCALE: AS SHOWN

DESIGNED: ML DATE: AUG 2021 DATE PRINTED: 6/09/2022

AUTHORISED: TS DATE: AUG 2021

SUITE 1, LEVEL 1, 84 MT ELIZA WAY, MT ELIZA VIC 3930
www.charltondegg.com.au

COUNCIL: CARDINIA SHIRE

TITLE: SOUTHERN SUSTAINABLE DEVELOPMENTS (OFFICER) PTY LTD
ARBOR - STAGE 2
STARLING ROAD, OFFICER
DETAIL PLAN & SERVICE OFFSET TABLE - SHEET 2

DRG NO. 1365_2_R06 REV. F SHEET 06 OF 40

SERVICE OFFSETS

Street	Gas	NDW	Water	Comms	Elec.	Lighting	Sewer
KINGFISHER RISE	N 1.85	N 2.35	N 2.85	S 1.85	S 2.50	0.90	BOK N 1.00 (Lot 234)
BURSARIA GROVE	E 1.85	E 2.35	E 2.85	W 1.85	W 2.50	0.90	BOK W 1.00 (Lot 232)
RINGTAIL GROVE	E 1.85	E 2.35	E 2.85	W 1.85	W 2.50	0.90	BOK W 1.00 (Lot 246)
FRESHWATER PLACE	N 1.00	N 1.50	N 2.00	S 1.85	S 1.40	0.90	BOK - -
TAWNY WAY	W 1.00	W 1.50	W 2.00	E 0.30	E 1.10	0.90	BOK - -
DUSKY WAY (Lot 209-226)	S 1.85	S 2.35	S 2.85	N 1.85	N 2.30	0.90	BOK - -
DUSKY WAY (Lot 204-209)	E 1.85	E 2.35	E 2.85	W 1.85	W 2.50	0.90	BOK W 1.00 (Lot 204)
NANKEEN RISE	S 1.85	S 2.35	S 2.85	S 1.00	N 0.60	0.90	BOK - -
CLUBBRUSH GROVE	E 1.85	E 2.35	E 2.85	W 1.85	W 2.40	0.90	BOK W 1.00 (Lot 222)

SERVICE OFFSETS ARE MEASURED (m) FROM THE TITLE BOUNDARY UNLESS OTHERWISE SPECIFIED

APPROVED FOR CONSTRUCTION
CARDINIA SHIRE COUNCIL

Ref No.: S21-053
Sheet: 6 of 40
Approved by: Justin Conn
CARDINIA SHIRE COUNCIL
Date: Thursday, 6 October 2022