

APPROVED FOR CONSTRUCTION

CARDINIA SHIRE COUNCIL

Ref No.: S21-155

Sheet: 4 of 24

Approved by: Justin Conn

CARDINIA SHIRE COUNCIL

Date: Monday, 20 February 2023

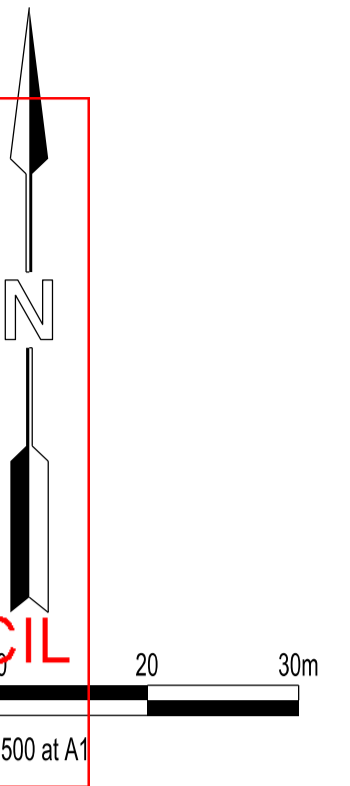

REFER TO BROWN ROAD PLANS (SEPARATE)

**WARNING**  
OVERHEAD POWER LINES

**STOP**  
Major Cables exist in the area, if your activities are within Telstra encroachment distances (see duty of care) contact 03 9632 9961 at least 2 business days before starting activity.

**WARNING**  
BEWARE OF UNDERGROUND SERVICES  
THE LOCATIONS OF UNDERGROUND SERVICES ARE APPROXIMATE ONLY AND THEIR EXACT POSITION SHOULD BE PROVEN ON SITE. NO GUARANTEE IS GIVEN THAT ALL EXISTING SERVICES ARE SHOWN.

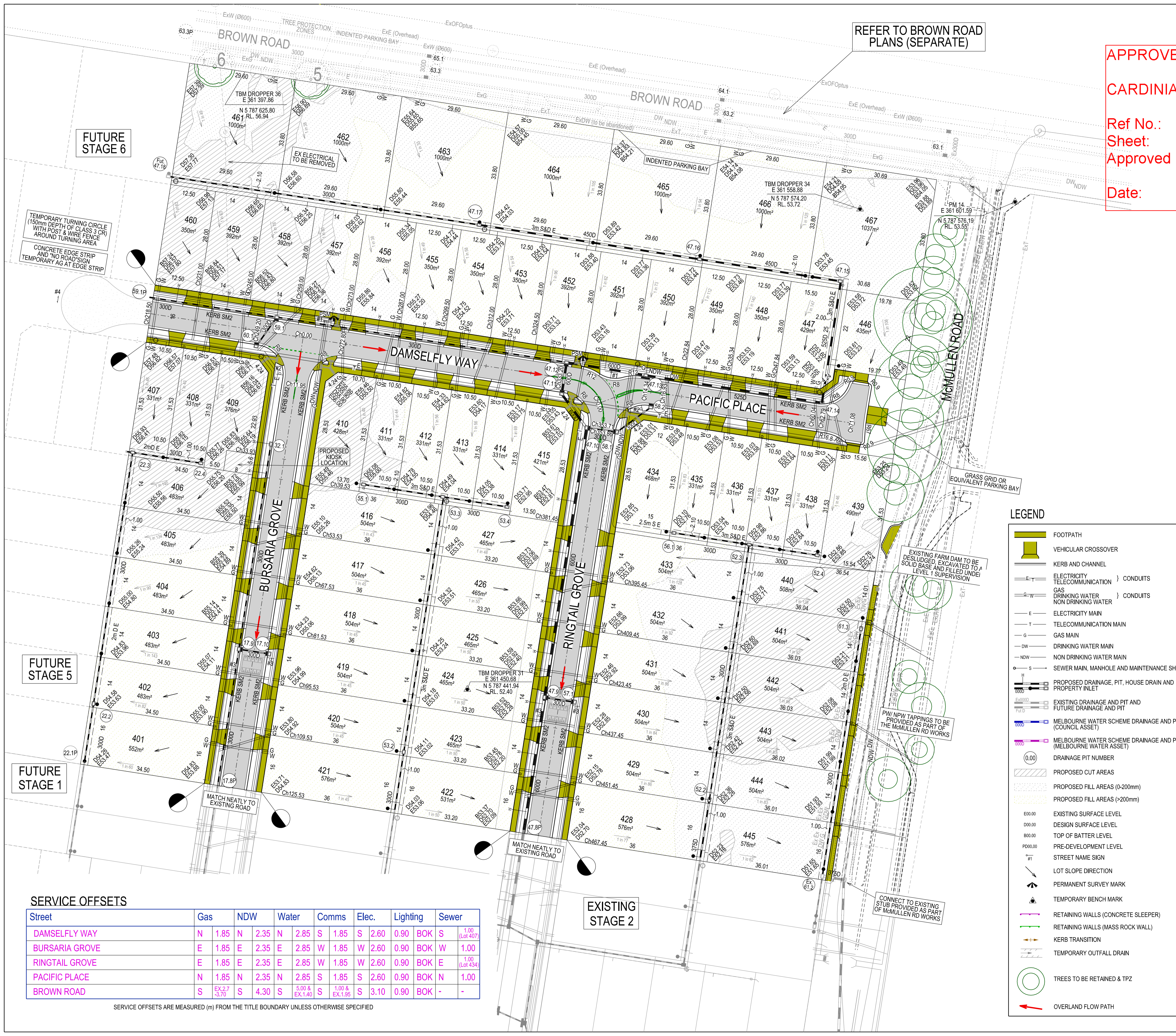

**LEGEND**

- FOOTPATH
- VEHICULAR CROSSOVER
- KERB AND CHANNEL
- ELECTRICITY TELECOMMUNICATION CONDUITS
- GAS DRINKING WATER NON DRINKING WATER CONDUITS
- ELECTRICITY MAIN TELECOMMUNICATION MAIN
- GAS MAIN DRINKING WATER MAIN NON DRINKING WATER MAIN SEWER MAIN, MANHOLE AND MAINTENANCE SHAFT
- PROPOSED DRAINAGE, PIT, HOUSE DRAIN AND PROPERTY INLET
- EXISTING DRAINAGE AND PIT AND FUTURE DRAINAGE AND PIT
- MELBOURNE WATER SCHEME DRAINAGE AND PIT (COUNCIL ASSET)
- MELBOURNE WATER SCHEME DRAINAGE AND PIT (MELBOURNE WATER ASSET)
- DRAINAGE PIT NUMBER
- PROPOSED CUT AREAS
- PROPOSED FILL AREAS (0-200mm)
- PROPOSED FILL AREAS (>200mm)
- EXISTING SURFACE LEVEL
- DESIGN SURFACE LEVEL
- TOP OF BATTER LEVEL
- PRE-DEVELOPMENT LEVEL
- STREET NAME SIGN
- LOT SLOPE DIRECTION
- PERMANENT SURVEY MARK
- TEMPORARY BENCH MARK
- RETAINING WALLS (CONCRETE SLEEPER)
- RETAINING WALLS (MASS ROCK WALL)
- KERB TRANSITION
- TEMPORARY OUTFALL DRAIN
- TREES TO BE RETAINED & TPZ
- OVERLAND FLOW PATH

**VERSION DETAILS:**

REV	DATE	DESCRIPTION	STATUS
A	04/10/2021	PRELIMINARY PLANS	PRELIMINARY
B	28/01/2022	VEHICLE CROSSING CHANGE LOT 465	PRELIMINARY
C	30/05/2022	COUNCIL SUBMISSION	PRELIMINARY
D	19/07/2022	DRIVEWAY AMENDMENT TO LOT 465	PRELIMINARY
E	27/10/2022	CONSTRUCTION ISSUE WITH COUNCIL COMMENTS DATED 27/10/2022	PRELIMINARY
F	17/11/2023	MINOR DRAINAGE, SEWER & PAVEMENT MAKE UP AMENDMENTS	PRELIMINARY

FILENAME: P:\1365\1365\_4IE2 - Design\6 - DGN\R04.dgn

DRAWN: SD	DATE: NOV 2021	SCALE: AS SHOWN
DESIGNED: ML	DATE: NOV 2021	DATE PRINTED: 17/01/2023
AUTHORISED: TS	DATE: NOV 2021	

**SERVICE OFFSETS**

Street	Gas	NDW	Water	Comms	Elec.	Lighting	Sewer
DAMSELY WAY	N 1.85	N 2.35	N 2.85	S 1.85	S 2.60	0.90	BOK S 1.00 (Lot 407)
BURSARIA GROVE	E 1.85	E 2.35	E 2.85	W 1.85	W 2.60	0.90	BOK W 1.00
RINGTAIL GROVE	E 1.85	E 2.35	E 2.85	W 1.85	W 2.60	0.90	BOK E 1.00 (Lot 434)
PACIFIC PLACE	N 1.85	N 2.35	N 2.85	S 1.85	S 2.60	0.90	BOK N 1.00
BROWN ROAD	S EX.2.7 -3.70	S 4.30	S EX.1.40	S 1.00 & EX.1.95	S 3.10	0.90	BOK -

SERVICE OFFSETS ARE MEASURED (m) FROM THE TITLE BOUNDARY UNLESS OTHERWISE SPECIFIED

enviro DEVELOPMENT ARBOR OFFICER

**CHARLTON DEGG**  
LAND DEVELOPMENT CONSULTANTS  
SUITE 1, LEVEL 1, 84 MT ELIZA WAY, MT ELIZA VIC 3930  
www.charltondegg.com.au

COUNCIL: CARDINIA SHIRE

TITLE: SOUTHERN SUSTAINABLE DEVELOPMENTS (OFFICER) PTY LTD ARBOR - STAGE 4 STARLING ROAD, OFFICER

DETAIL PLAN & SERVICE OFFSET TABLE

DRG NO. 1365_4/R04	REV. F	SHEET 04 OF 24
--------------------	--------	----------------